

DESCRIPTION

The ETN3060 temperature sensor is designed to measure external temperature conditions. The sensor body is IP65 rated and made from Flame Retardant Polycarbonate. The sensor element is encapsulated to prevent the influence of condensation in low temperature conditions.

FEATURES

- IP65 housing
- Flame Retardant Polycarbonate Body
- Encapsulated sensor element



SPECIFICATION

Material Body:	Flame Retardant Polycarbonate
Sensing Elements:	2.2K3A NTC Thermistor
Accuracy:	+0.2°C @ 70°C Thermistor
Operating Temperature:	-50 to + 70°C - 30°C to + 60°C
Terminals:	1.0mm recommended 2.5mm max
Location:	North facing wall not influenced by direct sun light
Order Code:	ETN3060

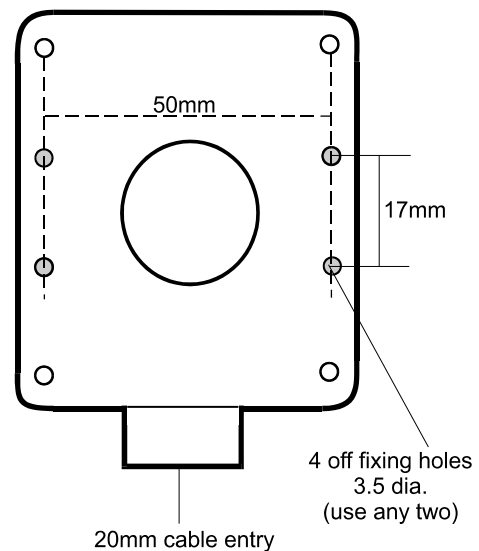
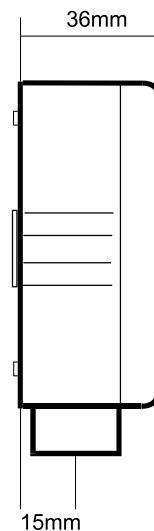
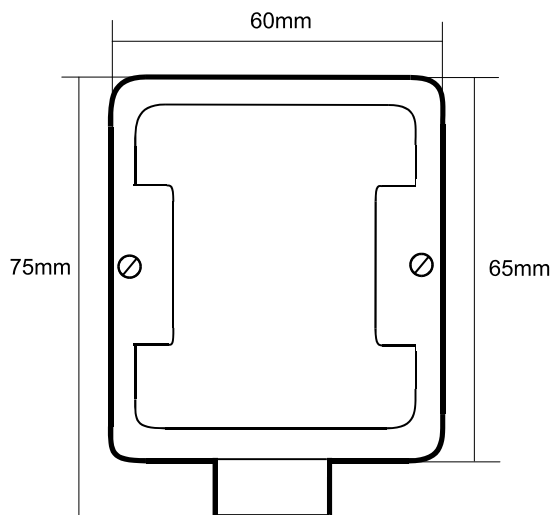

Ambiflex Ltd
12 Attenbury's Park Estate
Attenbury's Lane
Timperley, Cheshire
WA14 5QE
Tel: 0161 973 4411
Fax: 0161 973 3770

AMBIFLEX DATA SHEET:
ETN3060 External Sensor